

 **YAMAHA**  
**ACCESSORIES**

*C.B. RADIO KIT*  
*for XVZ12.*

**INSTALLATION MANUAL**

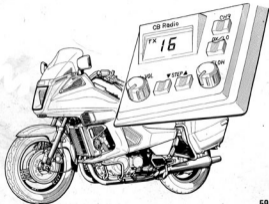

59J-2819Y-21

## FOREWORD

This manual provides the information required for the installation of the Citizen Band (C.B.) radio. Please read this manual carefully before starting installation of this radio.

**NOTE:**

Some data in this manual may become outdated due to future improvement on this C.B. radio.

TECHNICAL PUBLICATIONS  
SERVICE DIVISION  
MOTORCYCLE OPERATIONS  
YAMAHA MOTOR CO., LTD.

**C.B. RADIO KIT for XVZ12  
INSTALLATION MANUAL**

© 1985 by Yamaha Parts Distributors, Inc.

1st Edition, November 1985

All rights reserved. Any reprinting or  
unauthorized use without the written  
permission of Yamaha Parts Distributors, Inc.  
is expressly prohibited.

Printed in Japan

## CONTENTS

ACCESSORIES GUIDES .....	1
HOW TO USE THIS MANUAL .....	2
PARTS CHECK LIST .....	3
REMOVAL .....	6
SETUP PROCEDURES .....	11
WIRING DIAGRAM .....	30
CABLE ROUTING .....	31
PANEL CONTROLS AND INDICATOR .....	33
C.B. RADIO .....	33
C.B. RADIO REMOTE CONTROLLER .....	34
OPERATING PROCEDURE .....	35
PREDelivery SERVICE .....	36
TROUBLESHOOTING CHART .....	37
APPENDICES .....	49
CHANNEL INFORMATION .....	49
SPECIFICATIONS .....	50

## ACCESSORIES GUIDES

Necessary accessory parts and kits are different according to the type of customer's motorcycle (XVZ12 VENTURE or VENTURE ROYAL). By reference to the list below, make ready the necessary accessory parts and kits for customer's motorcycle before setup.

Part name or Kit name	Part No. or Kit No.	Type					
		'83		'84		'85	
		V	R	V	R	V	R
Wireless C.B. kit	59J-W8818-00	○	○	○	○	○	○
Blind panel kit	59J-W2824-00	○	X	○	X	○	X
Cable (1.5 m)	26H-88197-00	○	○	○	○	○	○
Head set (For open faced helmet)	26H-W0773-00	○	○	○	○	○	○
Head set (For full faced helmet)	26H-W0774-00	○	○	○	○	○	○
Replacement parts set for audio system	26H-W8810-00	○	○	○	○	○	○

V : XVZ12 VENTURE

R : XVZ12 VENTURE ROYAL

○ : Necessary

X : Unnecessary

## HOW TO USE THIS MANUAL

1. The numerals used in the "REMOVAL" and "SETUP PROCEDURES" section represent the order of removal and installation.
2. Before removing parts relating to the "REMOVAL" section, read the "Notes on removal" carefully and follow the instructions given.
3. Before installing parts relating to the "SETUP PROCEDURES" section, read the "Setup points" carefully and follow the instructions given.
4. The "\*" marked parts are reused parts.  
(Example)

### Parts list

No.	Part name	Q'ty	Remarks
*1	Console box panel	1	
*2	Panhead screw with plain washer	9	d = 5 mm (0.20 in), ℓ = 15 mm (0.59 in)
*3	Terminal panel	1	
4	Panhead screw		d = 4 mm (0.16 in), ℓ = 16 mm (0.62 in)

5. Particularly important information is distinguished in this manual by the following notations.

#### NOTE:

A NOTE provides key information to make procedures easier or clearer.

#### CAUTION:

A CAUTION indicates special procedures that must be followed to avoid damage to the C.B. radio.

#### WARNING:

A WARNING indicates special procedures that must be followed to avoid injury to a C.B. radio operator.

## PARTS CHECK LIST

Before starting the setup, check for damaged or missing parts (list below).

### A. WIRELESS C.B. KIT (59J-W8818-00)

No.	Part name	Q'ty	Remarks
1	Tapping screw	2	97702-40510 d = 4 mm (0.16 in), $\ell$ = 10 mm (0.40 in)
2	Spring nut	6	90183-04039 d = 4 mm (0.16 in)
3	Plain washer	6	92906-04600 d = 4 mm (0.16 in), D = 8 mm (0.32 in)
4	Hexagon socket head bolt	6	91316-04016 d = 4 mm (0.16 in), $\ell$ = 16 mm (0.64 in)
5	Plug	6	90338-07175 Plastic
6	Damper	2	26H-2843A-00 Rubber
7	Plain washer	2	92902-04600 d = 4 mm (0.16 in), D = 8 mm (0.32 in)
8	Hexagon nut	2	95302-04600 d = 4 mm (0.16 in)
9	Panhead screw	2	98502-04010 d = 4 mm (0.16 in), $\ell$ = 10 mm (0.40 in)
10	Spring washer	2	92902-04100 d = 4 mm (0.16 in), D = 8 mm (0.32 in)
11	Hexagon bolt	1	97306-10016 d = 10 mm (0.40 in), $\ell$ = 16 mm (0.64 in)
12	Plain washer	1	92906-10600 d = 10 mm (0.40 in), D = 18 mm (0.72 in)
13	Accessory bracket	1	59J-28242-00
14	Terminal panel	1	59J-28221-00
15	Accessory panel	1	59J-28222-00
16	Lock assembly	1	1HX-21780-00
17	C.B. radio assembly	1	59J-88180-00
18	C.B. radio cable	1	59J-88186-00
19	Matching box assembly	1	59J-88185-00
20	Matching box cover	1	59J-8818A-00
21	CLASS sub leads	1	59J-82509-00
22	C.B. radio remote controller	1	26H-88183-01
23	Noise filter assembly	1	26H-88188-00
24	Band	1	12R-82591-00
25	C.B. radio sub leads	1	59J-88189-00
26	C.B. radio registration card and warranty guide	1	90894-85500
27	C.B. radio owner's manual	1	59J-2819Y-90
28	Antenna pole	1	26H-88143-00

**A. WIRELESS C.B. KIT (59J-W8818-00)**

No.	Part name	Q'ty	Remarks
29	Noise filter	1	1NL-88188-00
30	Sheet	1	59J-88179-00 For noise filter
31	Noise filter sub lead	1	59J-82507-00 For noise filter
32	Smoothing condenser	1	1NL-81985-00
33	Band	1	7H9-87188-00 For smoothing condenser
34	Smoothing condenser sub lead	1	59J-81971-00 For smoothing condenser
35	Earth plate	2	90501-142E6

**B. BLIND PANEL KIT (59J-W2824-00)**

No.	Part name	Q'ty	Remarks
1	Blind panel	1	26H-28243-00
2	Damper	1	26H-28247-00, Rubber
3	Hook	2	26H-28248-01
4	Tapping screw	4	97702-40508 d = 4 mm (0.16 in), l = 8 mm (0.32 in)

**C. HEAD SET FOR OPEN FACED HELMET (26H-W0773-00)**

No.	Part name	Q'ty	Remarks
1	Head set (For open faced helmet)	1	26H-88190-00
2	Installation/operation manual	1	26H-2819Y-30

**D. HEAD SET FOR FULL FACED HELMET (26H-W0774-00)**

No.	Part name	Q'ty	Remarks
1	Head set (For full faced helmet)	1	26H-88193-00
2	Installation/operation manual	1	26H-2819Y-30

**E. EXTENSION CABLE FOR HEAD SET**

No.	Part name	Q'ty	Remarks
1	Extension cable (For head set)	1	26H-88197-00 l = 1.5 mm (4.9 ft)

**NOTE:**

HEAD SET FOR OPEN FACED HELMET (26H-W0773-00), HEAD SET FOR FULL FACED HELMET (26H-W0774-00) and EXTENSION CABLE FOR HEAD SET are not included in C.B. radio kit.

**F. REPLACEMENT PARTS SET FOR AUDIO SYSTEM (26H-W8810-00)**

No.	Part name	Q'ty	Remarks
1	Panhead screw	2	98503-04012 d = 4 mm (0.16 in), t = 12 mm (0.48 in)
2	Spring washer	2	92903-04100 d = 4 mm (0.16 in), D = 8 mm (0.32 in)
3	Plain washer	2	90201-045K9 d = 4 mm (0.16 in), D = 15 mm (0.64 in)
4	Collar	2	90387-046N2 d = 4 mm (0.16 in)
5	Hexagon bolt	2	97003-06020 d = 6 mm (0.24 in), t = 20 mm (0.80 in)
6	Spring washer	2	92903-06100 d = 6 mm (0.24 in), D = 12 mm (0.48 in)
7	Collar	2	90387-066N3 d = 6 mm (0.24 in)
8	C.B. Bracket	1	59J-8818H-00
9	Amplifier controller	1	26H-88131-02
10	Antenna cable	1	59J-88146-00



## REMOVAL

Before starting the setup, remove the parts shown in illustrations.

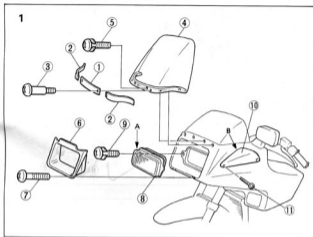

### Parts list

No.	Part name	Q'ty	Remarks
1	Outer molding (Center)	1	
2	Outer molding (Right and left)	2	
3	Screw	4	d = 5 mm (0.20 in), ℓ = 25 mm (0.98 in)
4	Wind screen	1	
5	Panhead screw with spring washer	4	d = 5 mm (0.20 in), ℓ = 16 mm (0.62 in)
6	Headlight cover	1	
7	Panhead screw	2	d = 4 mm (0.16 in), ℓ = 16 mm (0.62 in)
8	Headlight lens unit	1	
9	Panhead screw with spring washer	2	d = 4 mm (0.16 in), ℓ = 10 mm (0.39 in)
10	Front flasher light (Right and left)	2	
11	Tapping screw	4	d = 4 mm (0.16 in), ℓ = 20 (0.8 in)

### Notes on removal

A: Disconnect the female connectors from the wire harness.

B: Disconnect the flasher light leads from the wire harness.

**NOTE:**

If your motorcycle is XVZ12 VENTURE ROYAL, refer to figure 2A.

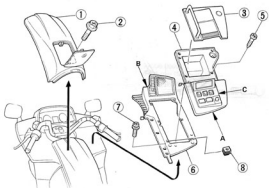
**2A****Parts list**

No.	Part name	Q'ty	Remarks
1	Top cover	1	
2	Hexagon screw with plain washer	1	d = 5 mm (0.20 in), ℓ = 20 mm (0.78 in)
3	Accessory panel	1	
4	Terminal panel	1	
5	Tapping screw	4	d = 5 mm (0.20 in), ℓ = 15 mm (0.59 in)
6	Console box panel (Right)	1	
7	Panhead screw with plain washer	9	d = 5 mm (0.20 in), ℓ = 15 mm (0.59 in)
8	Spring nut	6	d = 5 mm (0.20 in)

**Notes on removal**

- A: Before removing the terminal panel, disconnect the "CLASS" leads from the control unit.  
 B: Before removing the console box panel (Right), disconnect the "HAZARD" switch lead and the speaker leads from the wire harness.  
 C: Remove the "CLASS" control unit from the terminal panel.

**NOTE:**

If your motorcycle is XVZ12 VENTURE, refer to figure 2B.

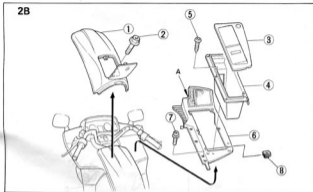
**Parts list**

No.	Part name	Q'ty	Remarks
1	Top cover	1	
2	Hexagon screw with plain washer	1	d = 5 mm (0.20 in), l = 20 mm (0.78 in)
3	Console box lid (Right)	1	
4	Console box (Right)	1	
5	Tapping screw	6	d = 5 mm (0.20 in), l = 15 mm (0.59 in)
6	Console box panel (Right)	1	
7	Panhead screw with plain washer	9	d = 5 mm (0.20 in), l = 15 mm (0.59 in)
8	Spring nut	6	d = 5 mm (0.20 in)

**Notes on removal**

A: Before removing the console box panel (Right), disconnect the "HAZARD" switch lead and the speaker leads from the wire harness.

3

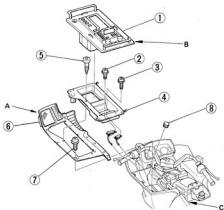

#### Parts list

No.	Part name	Q'ty	Remarks
1	Control unit	1	
2	Panhead screw with plain washer	2	d = 3 mm (0.12 in), l = 8 mm (0.32 in)
3	Panhead screw with plain washer	2	d = 3 mm (0.12 in), l = 8 mm (0.32 in)
4	Terminal panel	1	
5	Tapping screw	6	d = 5 mm (0.20 in), l = 15 mm (0.59 in)
6	Console box panel (Left)	1	
7	Panhead screw with plain washer	9	d = 5 mm (0.20 in), l = 15 mm (0.59 in)
8	Headlight beam adjusting knob	1	

#### Notes on removal

- A: Before removing the console box panel (Left), disconnect the speaker leads from the wire harness.  
 B: Remove the amplifier controller from the accessory panel.  
 C: Remove the antenna cable from the motorcycle.

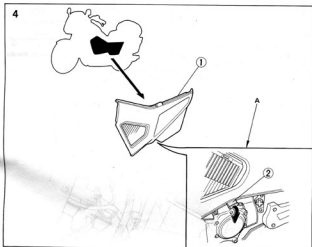

**Parts list**

No.	Part name	Q'ty	Remarks
1	Side cover	2	Right and left

**Notes on removal**

A: Before removing the side cover, unhook the band ② (cover holder) from the side cover.

## SETUP PROCEDURES

### CAUTION:

- Before starting the setup, make sure the main switch position turn to "OFF".
- Be careful not to drop the C.B. radio, Matching box assembly and any other audio parts. Handle them special care.

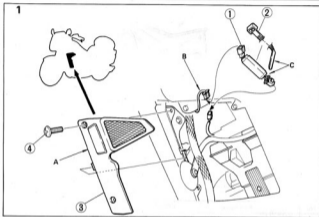

### Parts list

No.	Part name	Q'ty	Remarks
1	Noise filter assembly	1	26H-88188-00
2	Band	1	12R-82591-00
*3	Radiator cover (Left)	1	
*4	Binding screw	2	d = 5 mm (0.20 in), l = 15 mm (0.59 in)

### Setup points

- A: Before installing the noise filter assembly, remove the radiator cover from the radiator.  
 B: Disconnect the fan motor lead, then install the noise filter assembly.

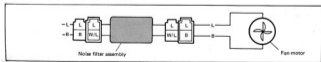

- C: Clamp the noise filter assembly to the frame with the band.

**CAUTION:**

Be sure to replace the antenna cable for maximum performance.

2

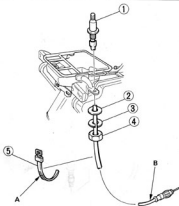
**Parts list**

No.	Part name	Q'ty	Remarks
1	Antenna cable	1	59J-88146-00
*2	Plain washer	1	d = 12 mm (0.48 in)
*3	Spring washer	1	d = 12 mm (0.48 in)
*4	Hexagon nut	1	d = 12 mm (0.48 in)
*5	Band	1	

**Setup points**

A: Clamp the antenna cable to the antenna stay with the band.

B: Route the antenna cable along side of the right side frame.

**NOTE:**

Use care so that cable is free from kinks, knots, pinches, and hitches. REFER TO "CABLE ROUTING".

3

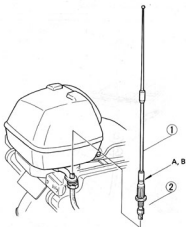

#### Parts list

No.	Part name	Q'ty	Remarks
1	C.B. antenna	1	26H-88143-00
*2	Gasket	1	

Replace the AM/FM antenna (for the tuner) with the C.B. antenna.

#### NOTE:

The C.B. antenna can be used both for the AM/FM Tuner and the C.B. Radio. If the antenna is not replaced with the C.B. antenna, you can't communicate with your friends.

#### Setup points

A: The antenna is a one-way folding type. Mount it so it can be folded straight forward and backward.



B: To store the motorcycle, bend the antenna pole by loosening its stem holder.

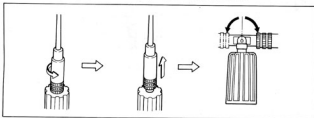

**CAUTION:**

Always keep the antenna pole up right while riding the motorcycle.

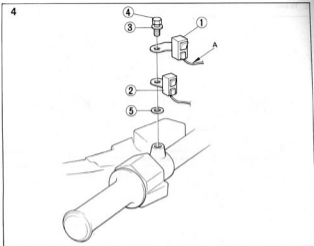

**Parts list**

No.	Part name	Q'ty	Remarks
1	C.B. radio remote controller	1	26H-88183-01
*2	Audio controller	1	
3	Hexagon bolt	1	97306-10016 d = 10 mm (0.4 in), l = 16 mm (0.64 in)
4	Plain washer	1	92906-10600 d = 10 mm (0.4 in), D = 18 mm (0.72 in)
*5	Plain washer	1	Only one washer is used

**NOTE:**

Mounting brackets of C.B. radio remote controller ① and audio controller ② are interchangeable and can be exchanged to reposition C.B. radio remote controller ① closer to operators hand for easier access to controller buttons.

**Setup point**

A: Route the C.B. radio remote controller lead along side of the left handlebar switch lead.

**NOTE:**

Use care so that lead is free from kinks, knots, pinches, and hitches. REFER TO "CABLE ROUTING".

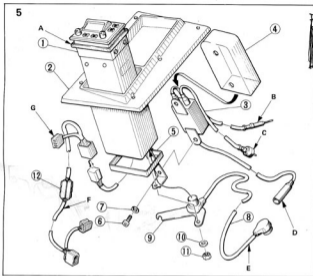

Parts list

No.	Part name	Q'ty	Remarks
1	C.B. radio assembly	1	59J-88180-00
2	Terminal panel	1	59J-28221-00
3	Matching box assembly	1	59J-88185-00
4	Matching box cover	1	59J-8818A-00
5	Accessory bracket	1	59J-28242-00
6	Panhead screw	2	98502-04010 d = 4 mm (0.16 in), l = 10 mm (0.40 in)
7	Spring washer	2	92902-04100 d = 4 mm (0.16 in), D = 8 mm (0.32 in)
8	C.B. radio cable	1	59J-88186-00
9	C.B. bracket	1	59J-8818H-00
10	Plain washer	2	92902-04600 d = 4 mm (0.16 in), D = 8 mm (0.32 in)
11	Hexagon nut	2	95302-04600 d = 4 mm (0.16 in)
12	C.B. radio sub lead	1	59J-88189-00

**Setup points**

A: Fit the damper to the C.B. radio.

**NOTE:**

Take care so that it isn't twisted.

B: Pass the cable through enough space between the inner panels. Then, connect it to the tuner cable.

**NOTE:**

Use care so that the cable is free from kinks, knots, pinches, and hitches.

REFER TO "WIRING DIAGRAM" AND "CABLE ROUTING".

C: Connect the cable to the female connector of the C.B. radio.

D: Pass the cable through enough space between the inner panels. Then, connect it to the antenna cable.

**NOTE:**

Use care so that the cable is free from kinks, knots, pinches, and hitches.

REFER TO "WIRING DIAGRAM" AND "CABLE ROUTING".

E: Pass the C.B. radio cable through enough space between the inner panels. Then, connect the DIN connector to the amplifier securely.

**NOTE:**

- Use care so that the cable is free from kinks, knots, pinches, and hitches.

REFER TO "WIRING DIAGRAM" AND "CABLE ROUTING".

- Before connecting the C.B. cable with the audio amplifier, insert and remove the DIN plug a few times for secure connection.

F: Pass the C.B. radio sub lead through inside of the fairing. Then, connect the female connectors to the audio wire harness.

G: Connect the male connectors to the C.B. radio remote controller lead.

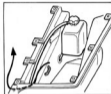
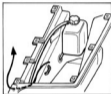

**NOTE:**

If your motorcycle is XVZ12 VENTURE, refer to figure 6A.

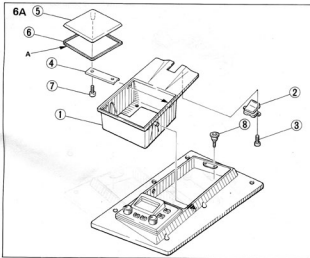
**Parts list**

No.	Part name	Q'ty	Remarks
1	Accessory panel	1	59J-28222-00
2	Lock assembly	1	1HX-21780-00
3	Tapping screw	2	97702-40510 d = 4 mm (0.16 in), $\ell$ = 10 mm (0.40 in)
4	Hook	2	26H-28248-01
5	Blind panel	1	26H-28243-00
6	Damper	1	26H-28247-00
7	Tapping	4	97702-40508 d = 4 mm (0.16 in), $\ell$ = 8 mm (0.32 in)
8	Damper	2	26H-2843A-00

**Setup point**

A: Fit the damper to the blind panel.

**NOTE:**

Take care so that it isn't twisted.

**NOTE:**

If your motorcycle is XVZ12 VENTURE ROYAL, refer to figure 6B.

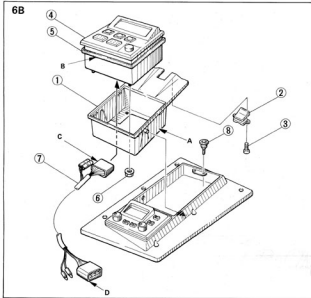
**Parts list**

No.	Part name	Q'ty	Remarks
1	Accessory panel	1	59J-28222-00
2	Lock assembly	1	1HX-21780-00
3	Tapping screw	2	97702-40510 d = 4 mm (0,16 in), t = 10 mm (0,40 in)
*4	CLASS control unit	1	
*5	Damper	1	
*6	Flange nut	4	d = 4 mm (0,16 in)
7	CLASS sub leads	1	59J-82509-00
8	Damper	2	26H-2843A-00

**Setup points:**

A: Before installing the CLASS control unit to the accessory panel, install the accessory panel to the terminal panel. If not, the accessory panel can't be set in the terminal panel.

B: Fit the damper to the CLASS control unit.

**NOTE:** \_\_\_\_\_

Take care so that it isn't twisted.

---

C: Connect the female connectors to the CLASS control unit with the identical color.

D: Connect the male connectors to the wire harness with the identical color.



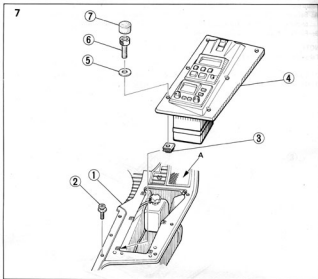

#### Parts list

No.	Part name	Q'ty	Remarks
*1	Console box panel	1	
*2	Panhead screw with plain washer	9	d = 5 mm (0.20 in), l = 15 mm (0.60 in)
3	Spring nut	6	90183-04039 d = 4 mm (0.16 in)
4	Terminal panel assembly	1	
5	Plain washer	6	92906-04600 d = 4 mm (0.16 in), D = 8 mm (0.32 in)
6	Hexagon socket head bolt	6	91316-04016 d = 4 mm (0.16 in), l = 16 mm (0.64 in)
7	Plug	6	90338-07175

#### Setup points

A: Connect the speaker leads and "HAZARD" switch leads to the wire harness.



**NOTE:**

Replace the encircled parts with the parts from the package (Kit No. 26H-WBB10).

**CAUTION:**

Be sure to replace the encircled parts for maximum performance.

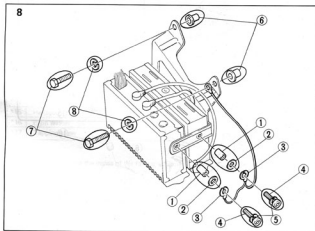
**Parts list**

No.	Part name	Q'ty	Remarks
1	Collar	2	90387-046N2 d = 4 mm (0.16 in)
2	Plain washer	2	90201-045K9 d = 4 mm (0.16 in), D = 16 mm (0.64 in)
*3	Audio ground lead	1	
4	Panhead screw	2	98503-04012 d = 4 mm (0.16 in), $\ell$ = 12 mm (0.48 in)
5	Spring washer	2	92903-04100 d = 4 mm (0.16 in), D = 8 mm (0.32 in)
6	Collar	2	90387-066N3 d = 6 mm (0.24 in)
7	Hexagon bolt	2	97003-06020 d = 6 mm (0.24 in), $\ell$ = 20 mm (0.80 in)
8	Spring washer	2	92903-06100 d = 6 mm (0.24 in), D = 12 mm (0.48 in)

**CAUTION:**

Be sure to replace the amplifier controller for maximum performance.

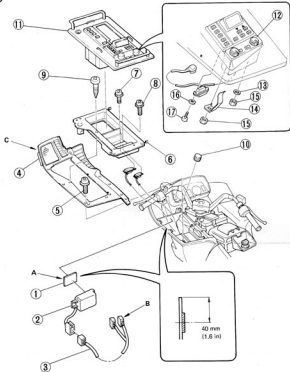
**9**

### Parts list

No.	Part name	Q'ty	Remarks
1	Sheet	1	59J-88179-00
2	Noise filter	1	1NL-88188-00
3	Noise filter sub lead	1	59J-82507-00
*4	Console box panel	1	
*5	Panhead screw with plain washer	9	d = 5 mm (0.20 in), t = 15 mm (0.59 in)
*6	Terminal panel	1	
*7	Panhead screw with plain washer	2	d = 3 mm (0.12 in), t = 8 mm (0.32 in)
*8	Panhead screw with plain washer	2	d = 3 mm (0.12 in), t = 8 mm (0.32 in)
*9	Tapping screw	6	d = 5 mm (0.20 in), t = 15 mm (0.59 in)
*10	Headlight beam adjusting knob	1	
*11	Control unit	1	
12	Amplifier controller	1	26H-88131-02
*13	Plain washer	1	d = 4 mm (0.16 in), D = 8 mm (0.32 in)
*14	Spring plate	1	
*15	Hexagon nut	2	d = 4 mm (0.16 in)
*16	Plain washer	2	d = 3 mm (0.12 in), D = 6 mm (0.24 in)
*17	Tapping screw	2	d = 3 mm (0.12 in), t = 10 mm (0.40 in)

#### Setup point

A: Affix the sheet ① on the inside of the fairing, as shown.

#### NOTE:

The areas for affixing sheet must be clear of dust, lint, etc.

- B: Pass the noise filter sub lead through inside of the fairing. Then, connect it to main wireharness and C.B. radio sub lead.

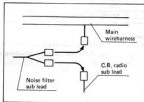

- C: Connect the speaker leads to the wireharness.

10

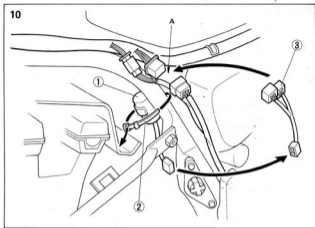

#### Parts list

No.	Part name	Q'ty	Remarks
1	Smoothing condenser	1	1NL-81965-00
2	Band	1	7H9-87188-00
3	Smoothing condenser sub lead	1	59J-81971-00

#### Setup point

A: Disconnect the rectifier/regulator leads (Red, Red, Brown, Black, Black) connector from the wireharness. Then, connect the smoothing condenser sub lead to the wireharness and rectifier/regulator leads.

11

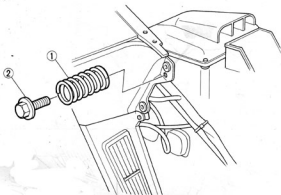

## Parts list

No.	Part name	Q'ty	Remarks
1	Earth plate	2	90501-142E6 Right and left side
*2	Flange bolt	2	d = 6 mm (0.24 in)

12

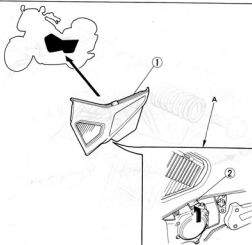

## Parts list

No.	Part name	Q'ty	Remarks
1	Side cover	2	Right and left

## Setup point

A: After installing the side cover, hook the band ② to the side cover.

13

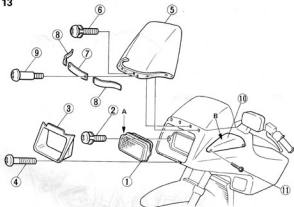

## Parts list

No.	Part name	Q'ty	Remarks
*1	Headlight lens unit	1	
*2	Panhead screw with spring washer	2	d = 4 mm (0.16 in), ℓ = 10 mm (0.39 in)
*3	Headlight cover	1	
*4	Panhead screw	2	d = 4 mm (0.16 in), ℓ = 16 mm (0.62 in)
*5	Wind screen	1	
*6	Panhead screw with spring washer	4	d = 5 mm (0.20 in), ℓ = 16 mm (0.62 in)
*7	Outer mole (Center)	1	
*8	Outer mole (Right and left)	2	
*9	Screw	4	d = 5 mm (0.20 in), ℓ = 25 mm (0.98 in)
*10	Front flasher light (Right and left)	2	
*11	Tapping screw	4	d = 4 mm (0.16 in), ℓ = 20 mm (0.8 in)

## Setup point

A: Connect the female connectors to the headlight lens unit.

B: Connect the flasher light lead to the wire harness.

14

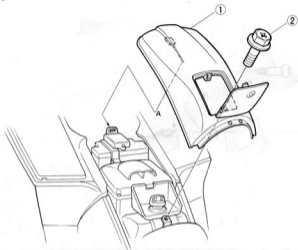

## Parts list

No.	Part name	Q'ty	Remarks
*1	Top cover	1	
*2	Hexagon screw with plain washer	1	d = 5 mm (0.20 in), $\ell$ = 20 mm (0.78 in)

## Setup point

A: Insert the top cover on to the frame.

## NOTE:

Insert the lobe on the top cover front into the receptacle on the frame.



# WIRING DIAGRAM

Disconnect the audio wire harness from the main wire harness. Next, connect the audio wire harness to the C.B. radio wire harness.

C.B. radio remote controller

Main wire harness

C.B. radio sub lead

Noise filter  
sub lead

C.B. radio

Noise filter

C.B. radio  
cable

Matching box cable  
(For C.B. radio)

Matching box

Extension cable  
(For head set)

Matching box  
cable (For antenna)

Matching box  
cable (For tuner)

Tuner cable

C.B. antenna

Antenna cable

Head set cable  
(Included in  
head set)

Head set  
(For full faced helmet)

Head set  
(For open faced helmet)

## CABLE ROUTING

**NOTE:**

Take care so that leads and cables are free from kinks, knots, pinches, and hitches.

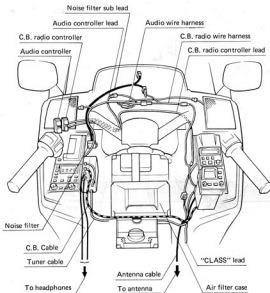

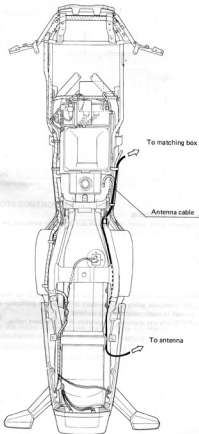

## PANEL CONTROLS AND INDICATOR

### C.B. RADIO

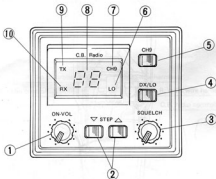

#### 1. "ON-VOL" CONTROL KNOB

Turn clockwise to apply power to the radio and to set the audio volume to the desired listening level. Turn fully counterclockwise to turn off the radio.

#### 2. "▼STEP▲" BUTTONS

These buttons select the desired channel for transmission and reception.

Each time this button is pressed, the channels changes one step (▼) downward or (▲) upward. Keeping the button pressed changes the channels consecutively downward or upward.

All channels, except channel 9, may be used for communications between stations operating under different license. Channel 9 has been reserved by the F.C.C. for emergency communications involving the immediate safety of individuals or immediate protection of property. Channel 9 also may be used to render assistance to a motorist.

This is an F.C.C. rule and applies to all operators of citizens band radios.

#### 3. "SQUELCH" CONTROL KNOB

This squelch control is rotated to cut off or eliminate received background noise in the absence of an incoming signal. For maximum receive sensitivity, it is desired that the control be rotated only to this point where the receive background noise or ambient background noise is eliminated. Turn the control fully counterclockwise, then slowly rotate clockwise until the receive noise disappears. In order to be heard, any signal must now be slightly stronger than the average received noise. Further clockwise rotation will increase the threshold level which a signal must overcome in order to be heard. Only strong signals will be heard at the maximum clockwise setting.

#### 4. "DX/LO" SELECTOR BUTTON

For normal reception, set the button to "DX". For a short-range communication or when signal is so strong as to produce a jarring note, set the button to "LO".

#### 5. "CH9" BUTTON

Depress this button for instant access to emergency channel 9. Depress again to return to the original channel.

#### 6. "LO" INDICATOR

This indicator is displayed when the "DX/LO" selector button is depressed.

#### 7. "CH9" INDICATOR

This indicator is displayed when the "CH9" button is depressed.

#### 8. CHANNEL INDICATOR

Liquid Crystal Display (LCD) indicates the channel number in use.

#### 9. "TX" INDICATOR

This indicator is displayed when the transmitter is in operation.

#### 10. "RX" INDICATOR

This indicator is displayed when an incoming signal is received.

### C.B. RADIO REMOTE CONTROLLER



#### 1. "Ch Up" SWITCH

When the top of this switch is pressed, the channel (1 to 40) changes consecutively in one increment. When the channel comes to 40, it starts all over again from 1. To stop at the required channel, press the bottom of this switch.

#### 2. "PTT (PUSH-TO-TALK)" SWITCH

The receiver and transmitter are controlled by the "PTT" switch. Press the switch and the transmitter is activated. Release the switch to receive.

## OPERATING PROCEDURE

### WARNING:

- It is very dangerous to operate C.B. radio controls except remote controls while riding; do not remove your hands from the handlebars.
- To ride safely, keep a moderate audio level.

### CAUTION:

- Do not use the C.B. radio for long time when the engine is off; battery energy might be used up.

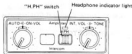

1. Connect the head set correctly.
2. Turn the main switch to "ACC" or "ON".
3. Select the headphones or speakers by pressing the "H.P.H." button. When headphones are selected the "H.P.H." indicator light will come on. If indicator light is off audio will be heard through speakers.

#### To Receive:

- a. Turn the "ON-VOL" control knob clockwise.
- b. Set the desired channel.
- c. Set the "ON-VOL" control knob to a comfortable listening audio level.
- d. Listen to the background noise from the speakers or headphones. Turn the squelch control slowly clockwise until the noise just disappears (no signal should be present). Leave the control at this setting.

The squelch is now properly adjusted. The receiver will remain quiet until a signal is actually received. Do not advance the control too far, or some of the weaker signals will not be heard.

#### To Transmit:

- a. Be sure the operator has read and understands part 95, F.C.C. Rules and Regulations prior to operating the transmitter.
- b. Select the desired channel.
- c. If the channel is clear, press the "PTT" switch on the C.B. radio remote controller and speak in a normal voice.

## PREDELIVERY SERVICE

1. Make sure the C.B. radio wire harness, remote controller lead, C.B. radio cable, antenna cable, etc. are all connected correctly.
2. Make sure all leads and cables are not twisted, damaged or pinched.
3. Turn on the C.B. radio and check that all switches operate normally.
4. Turn on the C.B. radio and check that reception is normal in all channels.
5. Turn on the C.B. radio and check that transmission is normal in all channels.
6. Some operators are interested in "fine tuning" their C.B. radios for the best transmission and reception. This is accomplished by matching as close as possible the Voltage Standing Wave Ratio (V.S.W.R.) of the antenna to the radio.

The V.S.W.R. can be checked using a SWR meter. Your local C.B. radio store can perform this test for you.

A ratio of 1 : 1 is a perfect match. Although 1 : 1.5 is acceptable, the closer you can get to a 1 : 1 match the better your transceiver will perform.

The V.S.W.R. is adjusted by changing the length of the upper portion of the antenna itself. Your local C.B. radio store will be able to provide more information about this procedure if you are interested.



## TROUBLESHOOTING CHART

Prior to troubleshooting, make sure the Tuner, Cassette deck, Headphones and Inter Communication are in good working condition.

Also, check that all type leads between the C.B. radio and the antenna are correctly connected.

1. The radio does not come on with the "ON-VOL." Control knob set to ON.

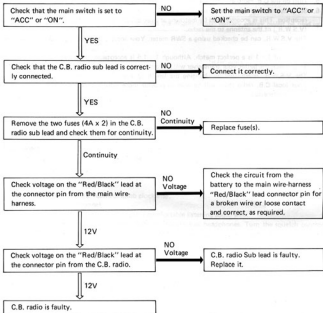



2. When the main switch or "ON-VOL." control knob has been set back to ON after once turned to OFF, the channel does not revert to the original.

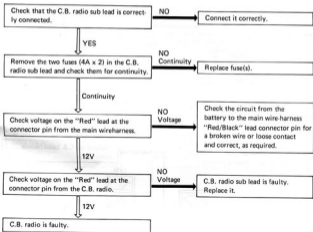

3. With the C.B. radio remote controller "Ch Up" switch set to ON, the channel does not shift up. (When "CH9" has been selected by pushing the "CH9" button on the C.B. radio, the channel will not shift up with the remote controller "Ch Up" switch set to ON.)

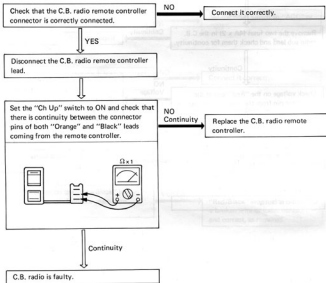

4. With the C.B. radio remote controller "Ch Up" switch turned off, the C.B. radio channel shifts up.

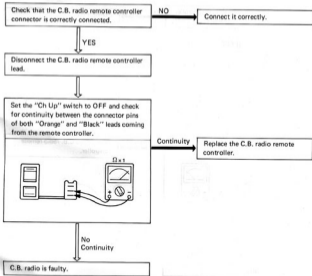

5. With the C.B. radio remote controller "PTT" switch turned on, the channel display does not show "TX".

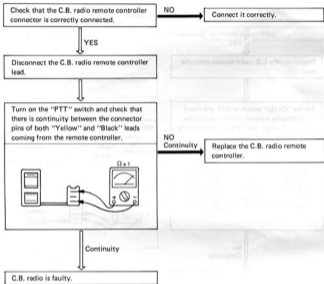

6. With the C.B. radio remote controller "PTT" switch turned off, the channel display shows "TX".

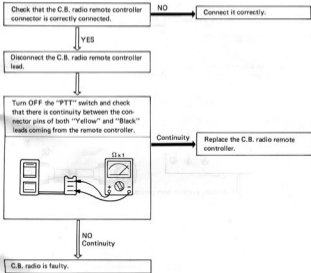

7. When the Cassette Deck or Tuner and the C.B. radio are being operated simultaneously, the C.B. radio receives signals from another C.B. radio on the same channel, and the Cassette Deck or Tuner audio level does not lower with "RX" shown on the channel display.

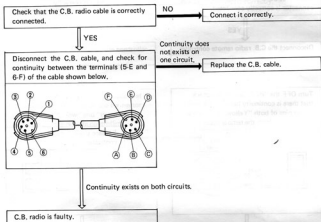

- B. The amplifier controller "ON-VOL" control knob is turned off and at the same time, the C.B. radio "ON-VOL" control knob is turned on, but the amplifier controller does not come on.

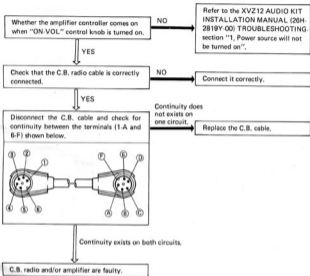

9. While signals are being received from a C.B. radio station, the channel display shows "RX" but no sound is heard from the head set.

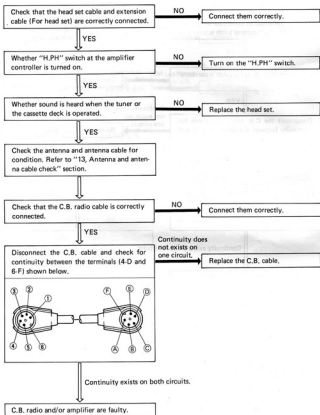



10. In communication with a C.B. radio station, no transmission of voice signals is possible.

**NOTE:**

There is no fault on the matching box when it is possible to receive a C.B. radio station.

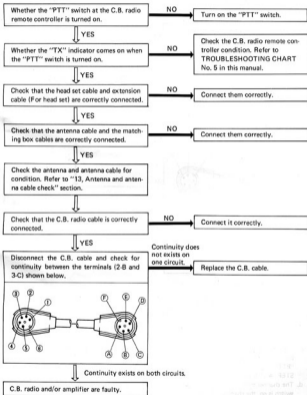

11. In communication with a C.B. station, abnormal noises are transmitted.

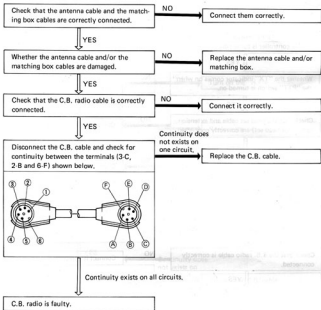

12. Set the C.B. radio "ON-VOL" control knob to ON and if any one of the following symptoms appears, the C.B. radio is considered to be faulty.

- The channel display illumination light is on but it shows no channel No.
- The channel display shows a channel No, but the illumination light is off.
- The channel does not shift up and down with each push of the "▼ STEP ▲" button. (Note that when channel 9 has been selected by pushing the "CH9" button or when the controller "PTT" switch is turned on, the channel will not shift up or down with each push of the "▼ STEP ▲" button.
- The channel shift to 9 with a push of the "CH9" button. (Note that when the controller "PTT" switch is on, the channel will not shift to 9 with a push of the "CH9" button.)
- With the "DX/LO" button pushed in, the channel display does not show "LO".

13. Antenna and antenna cable check.

Disconnect the antenna cable from the matching box cable.

Check the antenna and antenna cable for continuity as shown.

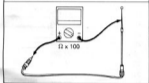

Continuity → The antenna and antenna cable are good.

NO Continuity

Remove the antenna from the antenna stay and check the antenna cable for continuity.

NO Continuity → Replace the antenna cable.

Continuity → Replace the antenna.

## APPENDICES

### CHANNEL INFORMATION

Channel	Channel Frequency in MHz	Channel	Channel Frequency in MHz
1	26.965	21	27.215
2	26.975	22	27.225
3	26.985	23	27.235
4	27.005	24	27.245
5	27.015	25	27.255
6	27.025	26	27.265
7	27.035	27	27.275
8	27.055	28	27.285
9	27.065	29	27.295
10	27.075	30	27.305
11	27.085	31	27.315
12	27.105	32	27.325
13	27.115	33	27.335
14	27.125	34	27.345
15	27.135	35	27.355
16	27.155	36	27.365
17	27.165	37	27.375
18	27.175	38	27.385
19	27.185	39	27.395
20	27.205	40	27.405

**NOTE:**

This radio has been designed for operation in the 11 meter Citizens Radio Service. It uses a frequency synthesizing circuit with Phase Locked Loop (PLL) techniques to provide crystal controlled transmit and receive operation on all 40 channels. The PLL circuitry assures ultraprecise frequency control. It is designed to meet the Federal Communications Commission requirements applicable to equipment operating in the Citizens Radio Service, and is not to be used for any other purpose.



**YAMAHA PARTS DISTRIBUTORS, INC.**

PRINTED IN JAPAN

85 • 11 • 05 • 1 CR

(■)